

# Open Frame Monitor

## Open Frame Monitor



46"(16:9)

### Specifications



Model Name	W46L100-OFL2
Viewable Size Image	46" (16:9)
Active Display Area(mm)	1018.08 (H) x 572.67 (V)
Pixel Pitch(mm)	0.53025
Number of Pixels	1920 x 1080
Contrast Ratio	4000:1(typ.)
Display Color	16.7M (8bit/colors)
Brightness(cd/m )	400(typ.)
Viewing Angle(CR>=10)	-89~89(H);-89~89(V)
Synchronization Range	31.5~91.1KHz / 50~85Hz
Horizontal/Vertical	
Recommended Resolution	1920 x 1080 @ 60Hz
Input Signal	VGA (D-sub)
	DVI-D
	HDMI
	Composite (BNC)
	S-video (Mini Din 4 Pin)
	Component (BNC)
	Audio
	RJ-45 (For Remote Control)
	RS232 (For Remote Control)

Output Signal	VGA (D-sub)
	Composite (BNC)
	Audio
	RS232 (For Remote Control)
Internal Speaker	10W + 10W
Power Source	AC100~240V, Universal, 10%
Optional Touch Screen	Optical (2 points)
Operating Temperature	5~40degC
Operating Humidity	20~80% (without condensation)
Dimension	1091.1(W) x 645.7(H) x 120.1(D)mm
VESA compatible arm mounting interface	200 x 200 mm/ 400 x 200mm
Certification	CE, FCC

### Mechanical Drawing

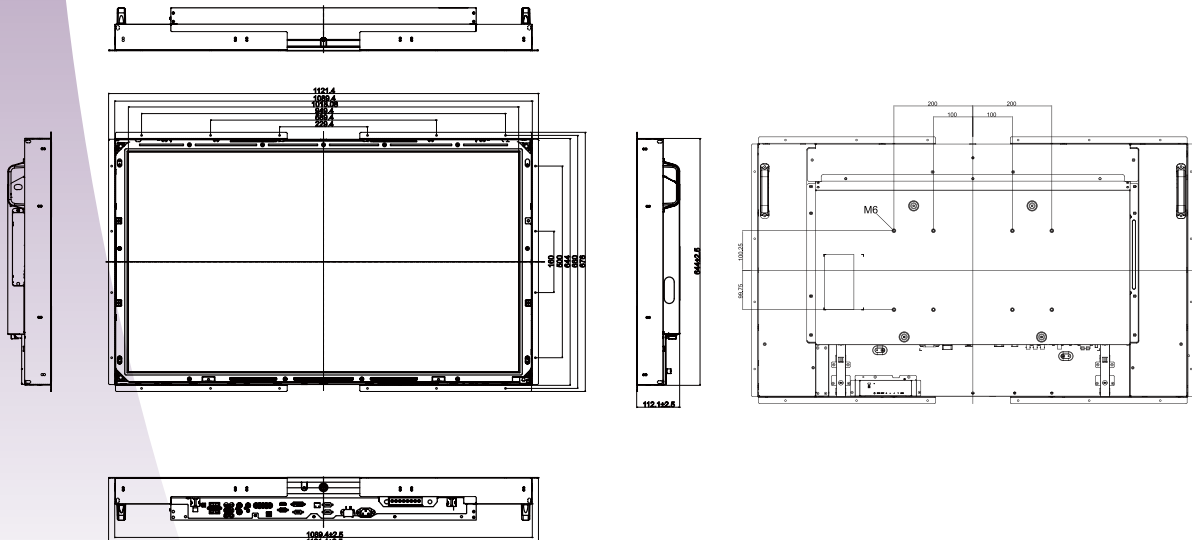

\* Please refer to next page for detail I/O introduction.

\* Note: this is a simplified drawing and some components are not marked in detail. Please contact our sales representative if you need further product information.

# Open Frame Monitor

## Open Frame Monitor

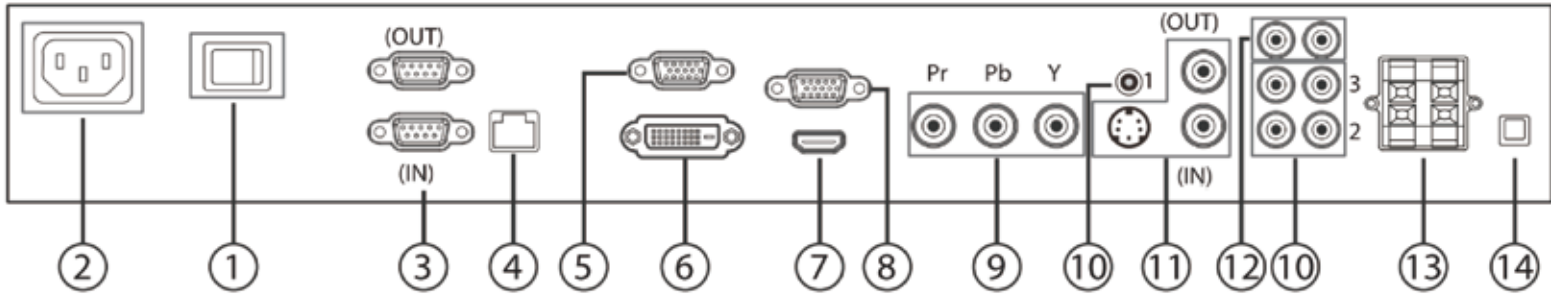

### ① MAIN POWER SWITCH

Press to switch the main power on/off.

### ② AC IN

Connect the supplied power cord to the wall outlet.

### ③ RS232C (OUT/IN) / Optional Touch (RS232/USB)

RS232C network input/output connection for the use of loop-through function.

With optional touch function, the RS232 (OUT/IN) port will be replaced by touch connector (RS232/USB)

Touch connector (RS232/USB)



### ④ RJ-45

LAN control function for the use of remote control signal from control center.

### ⑤ VGA OUT (D-Sub)

Output the VGA signal from the VGA IN (D-Sub).

### ⑥ DVI-D IN

Connect the DVI-D output of a PC, or the HDMI output of an AV device by using a DVI-HDMI cable.

### ⑦ HDMI IN

Connect the HDMI output of an AV device, or the DVI-D output of a PC by using a DVI-HDMI cable.

### ⑧ VGA IN (D-Sub)

Connect the computer VGA output.

### ⑨ COMPONENT IN (BNC)

Connect the component YPbPr output from external AV device.

### ⑩ AUDIO IN 1, 2, 3

Connect audio input from external AV device.

- **AUDIO IN 1:** 3.5mm stereo phone jack
- **AUDIO IN 2, 3:** RCA phone jack

### ⑪ VIDEO IN/OUT

- **S-VIDEO IN (Mini DIN 4 pin):** Connect the S-VIDEO (Y/C separate signal) input.
- **VIDEO IN (BNC):** Connect the composite video signal input.
- **VIDEO OUT (BNC):** Connect the composite video signal output from VIDEO IN (BNC).

### ⑫ AUDIO OUT R/L (RCA)

Connect the audio signal output from AUDIO IN 1, 2, or 3 jack to an external AV device.

### ⑬ SPEAKERS OUT R/L

Connect the audio output to external speakers.

### ⑭ SPEAKER SWITCH

Press to switch the internal speaker on/off.

Rev.	Reasons	Revised Date
1.1	Spec Change	Oct-31-12
1.2	Spec Change	Nov-09-12
1.3	Pic Change	Jun-29-13