

Connection technology

M23 connection technology

Cordsets, pre-assembled

With connector, 12 pin

Working temp. -30°C ... +80°C [-22°F ... +176°F]

Order no.

Female connector with coupling nut + single-ended

Cable: PVC, 6 x 2 x 0.14 mm² [AWG25]
Housing: metal, IP67

pin socket assignment cw

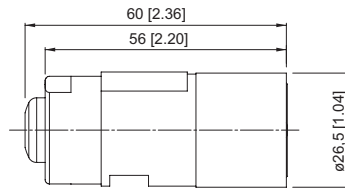
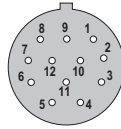

suitable for our series with RS422 or SinCos output:

KIS50 / KIH50	5000 / 5020
5805 / 5825 ³⁾	
5814 / 5834	5814FSx / 5834FSx ³⁾
A020 / A02H	H120

Terminal assignment

Pin female contacts:	1	2	3	4	5	6	7	8	9	10	11	12	PH ²⁾
Core color:	PK	RD-BU	BU	RD	GN	YE	-	GY	-	WH	GY-PK	BN	PH ²⁾

cable length¹⁾

standard cable length	2 m [6.56']
(available from 1 piece)	5 m [16.40']
	10 m [32.81']
	15 m [49.21']

8.0000.6901.0002
8.0000.6901.0005
8.0000.6901.0010
8.0000.6901.0015

other cable lengths
(available from 1 piece)

8.0000.6901.00xx
xx = length in meters:
1, 3, 8, 12, 20, 25, 30

1) Other cable lengths on request.

2) Shield on housing.

3) Connector color assignment is different from encoder color assignment.