



IN-STORE MARKETING AT A TOUCH TO ENHANCE THE SHOPPING EXPERIENCE

IN-STORE MULTITOUCH PRESENTER

THE IN-STORE MULTITOUCH PRESENTER ALLOWS COMPANIES TO ENHANCE THE SHOPPING EXPERIENCE TO MAXIMIZE THE IN-STORE ADVERTISEMENT POTENTIAL. COMBINE VIDEO, AUDIO, TEXT AND GRAPHICS TO VIRTUALLY SHOWCASE YOUR PRODUCTS AND SERVICES THROUGH THIS DIGITAL MEDIA TOOL. BRING IN THE ELEMENT OF ENTERTAINMENT TO GRAB CUSTOMER'S ATTENTION AND ENCOURAGE CUSTOMERS TO INTERACT WITH YOUR BRAND.

WHETHER IN RETAIL FOR WAYFINDING; AS PRODUCT INFORMATION SYSTEM OR DIGITAL SIGNAGE DISPLAY; AS HOTEL DIRECTORY, DIGITAL MENU BOARD FOR HOSPITALITY OR FOR UPSELLING USING INTERACTIVE AND DIGITAL MEDIA IN THE FORM OF A POS SYSTEM OR KIOSK.

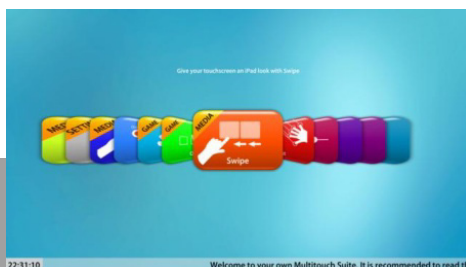

THE MULTITOUCH PRESENTER IS AN ALL-IN-ONE SOLUTION: ENGAGE CUSTOMERS THROUGH INTERACTIVE TECHNOLOGY, STRENGTHEN THEIR LOYALTY AND TIE THEM MORE CLOSELY TO YOUR BRAND.



- Multi Touch Panel designed for Customer Interaction
- 22" Resistive Full HD Multi Touch screen
- Robust Design; Built to Handle the Rigors of Intense Use in a Variety of Scenarios and Public Settings
- High Performance Intel Technology
- Cutting-Edge Thermal Design; Suitable for 24/7 Usage
- Pre-Installed Multilingual Operating System and User Interface
- Easy to Use and Customizable Multitouch Software with a wide variety of applications included:
 - Pinpointer
 - Mediaviewer
 - Webbrowser
 - Video
 - Videodraw
 - Puzzle
 - Quiz
 - Brochures
 - Timeline
 - Swipe

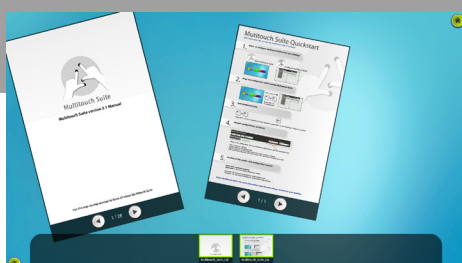



MULTITOUCH SOFTWARE SUITE

SET-UP AND INSTALLATION ARE MADE EASY WITH THE OS AND MULTITOUCH SOFTWARE SUITE PREINSTALLED, LOWERING IMPLEMENTATION COSTS AND TIME. THE PRECONFIGURED SOFTWARE SUPPORTS RICH INTERACTIVE APPLICATIONS, NEXT-GENERATION MEDIA EXPERIENCES AND MULTI-TOUCH FUNCTIONALITY.



FULLY CUSTOMIZABLE

ALL ELEMENTS WITHIN MULTITOUCH SUITE ARE CUSTOMIZABLE TO SUIT YOUR BRAND STYLE. COLORS, BACKGROUNDS, TEXTS, IMAGES AND MENU STRUCTURE ARE ALL EDITABLE. SIMPLY COLLECT THE MARKETING TOOLS AND MATERIALS FOR EACH APP AND INSTALL THEM ON THE TOUCH PC.



APPS TO SUIT YOUR EVERY NEED

INCLUDING TEN PROFESSIONAL APPLICATIONS TO PROMOTE BRAND AWARENESS AND ENTERTAIN CUSTOMERS. INTERACT AND ENGAGE YOUR CLIENTELE, WHILE CREATING TRAFFIC AND COLLECTING DATA. THE STANDARD APPLICATIONS ALLOW FOR: BROCHURES ON DISPLAY, A VIDEO PLAYER, WAYFINDING, A WEB BROWSER, USE OF RSS FEEDS AND GAMING APPS.

Dimensions	532 x 332x 60 mm (W x H x D)	Aspect Ratio	16:9
Weight	9kg/19.84 lbs	Button/Indicator	Power Button, Monitor Function Buttons, HDD indicator (red) x1, Power indicator (green) x1
CPU	Intel® Core™ i3 Second Generation Processor	System I/O	DC 20V Jack x1 VGA In Port (Monitor) x1 RS232 Port (Monitor) x2 VGA Out Port x1 (Duplex and External Mode) RJ45 LAN Jack x2 USB 2.0 x6 PC Legacy RS232 Serial Port (COM Port) (RI/5V/12 by Jumper Setting) x4 RS485 or RS422 (COM2 by Jumper Setting) x1 RJ11 for Cash Drawer (12V/20V by Jumper) x1 PC Legacy Printer Port x1 Audio Line-in x1, Line-out x1, Mic-in x1 Antenna Hole x3 Kensington Lock Hole x1
Memory	2 GB DDRIII SO-DIMM		
Video	VGA Output x1 VGA Input (Monitor) x1		
LAN	Dual Intel Gigabit Ethernet 10/100/1000 Built-in B/G/N WiFi		
Audio	5.1 Channel		
Expansion slot	Mini card Slot x1	Webcam	1.3MP x1
Mass Storage	320 GB Hard Disk	Mic	High Sensitivity Mic x1
LCD (LED Back light)	Default Resolution : 21.5" (1920 x 1080) Maximum Brightness : 250 nits	Mounting Kit	Wall Mount Kit x1
Touch Panel	Multi Touch 4 Wire, 10 points Resistive	Accessories	90W PWR Adapter x1 Power Cord x1 Utilities & Drivers CD x1 EIG x1

IN-STORE MULTITOUCH PRESENTER